



**Corelli Close, Stratford-Upon-Avon, CV37 9PU**

**SHELDON  
BOSLEY  
KNIGHT**

LAND AND  
PROPERTY  
PROFESSIONALS



# Property Description

\*Garage & Allocated Parking\*

An ideal first time purchase or investment opportunity, this well-presented first floor apartment is situated in a popular and convenient location.

The property opens with a welcoming entrance hallway that includes a useful storage cupboard, leading through to a bright and spacious open plan lounge and dining area. The separate kitchen is fully fitted and provides ample space for a table and chairs, making it a functional and sociable space.

There are two well proportioned double bedrooms, with the principal bedroom benefitting from built in storage. The bathroom is generously sized and features both a bath and a separate shower.

The apartment has been redecorated throughout and fitted with new carpets, ensuring it is ready for immediate occupation.

With its excellent condition and strong rental track record, this property presents a fantastic opportunity for first time buyers and investors alike.







## Key Features

- First Floor Apartment
- Two Double Bedrooms
- Lounge Diner
- Kitchen
- Bathroom With Separate Shower
- Garage & Allocated Parking
- Redecorated Throughout & New Carpets
- Ideal First Time or Investment Purchase
- No Onward Chain

**Offers Over  
£170,000**



## GROUND FLOOR

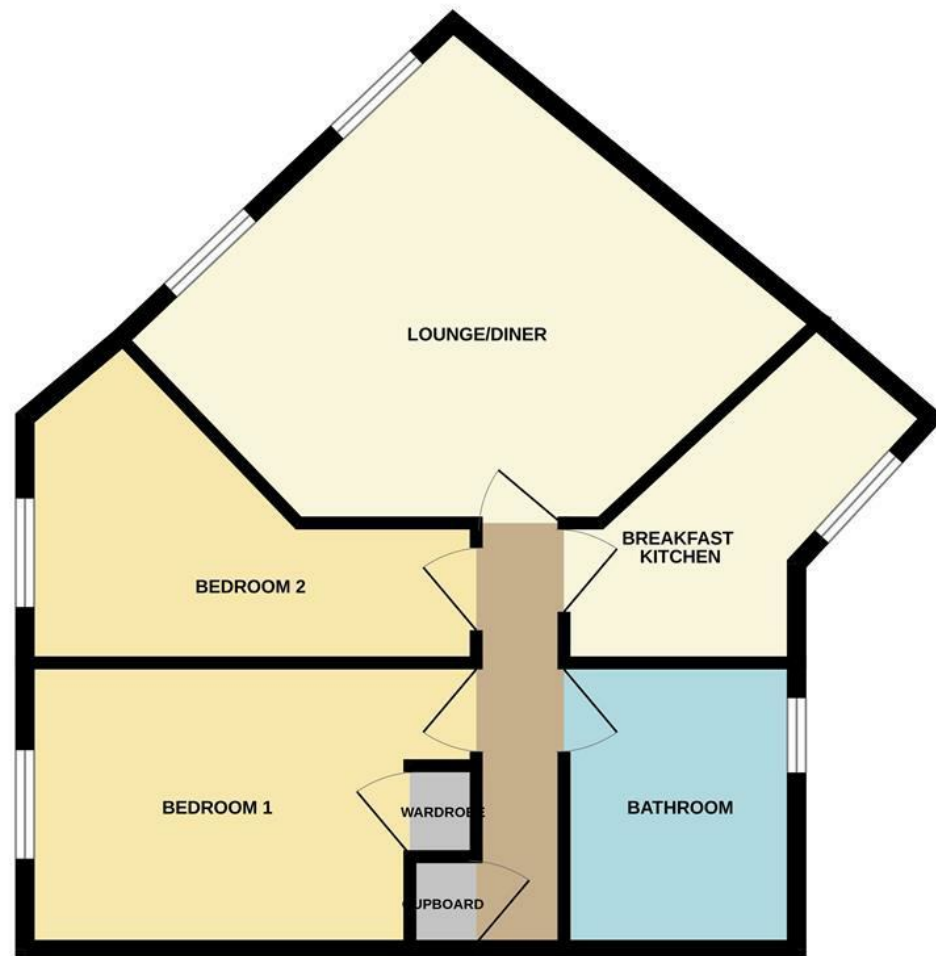

This floor plan is not to scale and is for guidance purposes only  
Made with Metropix ©2025



EPC Rating - C

Tenure - Leasehold

Council Tax Band - C

Local Authority  
Stratford-upon-Avon





We routinely refer clients to both our recommended legal firm and a panel of financial services providers. It is your decision whether you choose to deal with these companies. In making that decision, you should know that we receive a referral fee.

**SHELDON  
BOSLEY  
KNIGHT**

LAND AND  
PROPERTY  
PROFESSIONALS